

Thank you for purchasing our Terni outdoor wall lighting equipment. The device has an adjustable PIR sensor. The device is suitable for installation on outdoor walls as well as indoors. Before installing and using the device, please read this manual carefully and pay attention to the safety warnings and instructions. This will ensure not only the protection of persons, but also the long-term viability of the equipment. Do not repair or modify the equipment, installation must only be carried out by a qualified technician. The operating temperature of the equipment is between -20°C and 50°C.

#### Technical parameters

	WO813
Power	220-240V AC
Consumption	12W
Luminous flux	560lm
Chromaticity	3000K
Colour rendering index Ra	>80
Degree of protection	IP 44
Dimensions	125 x 85 x 135 mm

#### Installation

Disconnect the power supply before installation!

1. Unscrew the side screws on the bottom and top of the device.
2. Remove the metal cover and slide the luminaire base plate out of the light-permeable cover.
3. Push the supply cable through the rubber hole in the base plate. (If the cable cannot be pushed through, make a thin hole in the rubber seal.)
4. Insert dowels into the pre-drilled holes and screw the base plate into the selected location.
5. Connect the supply cable to the terminal board and ensure that the connection is correct! (Refer to the terminal block for wiring markings)
6. Place the light-permeable cover on the base plate and then the metal cover.
7. Screw in the screws on the top and bottom of the unit.

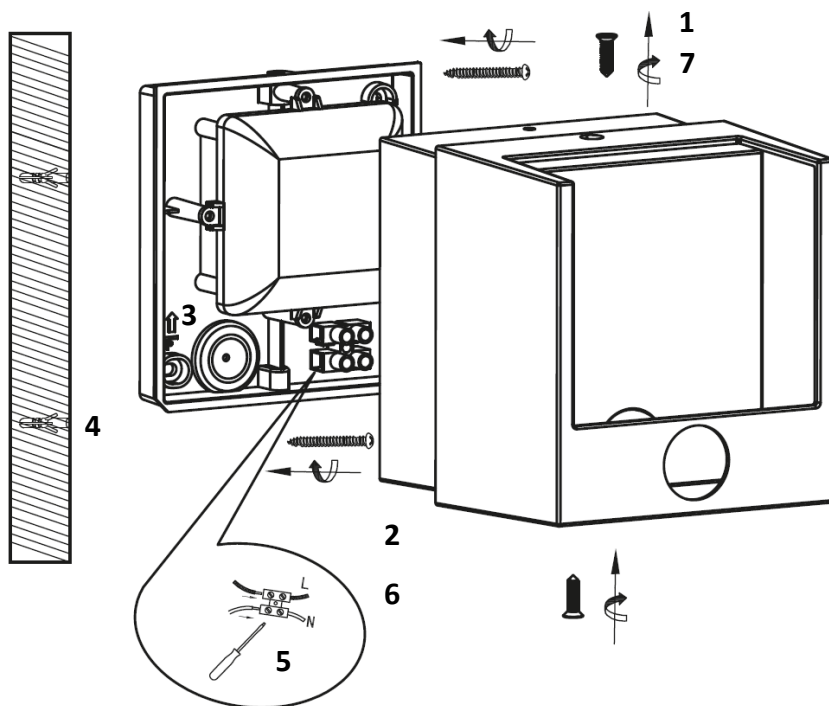

Pic. 1

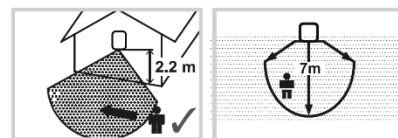

#### Safety warning

- Installation may only be carried out by a qualified worker.
- Do not cover the luminaire with anything or hang anything on it.
- Do not repair or modify the equipment in any way.

#### PIR sensor

The most suitable **placement of the device** is up to a height of 2.2m. Under these conditions, the sensor will sense people up to 7m away. For the sensor to work properly, position it so that people walk past the sensor, not towards it (see Figure 1)

**The detection angle** of the sensor can be adjusted by means of a slider, which is able to cover up to half of the sensor area (see Figure 2).

Adjust the sensor **sensitivity** by turning the dial on the left side.

You can adjust the **duration** of illumination (min. 5s | max. 5 min) after motion detection by turning the wheel on the right side (see Figure 3)

Pic. 2

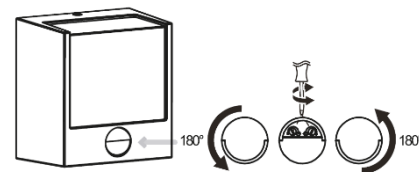

Pic. 3

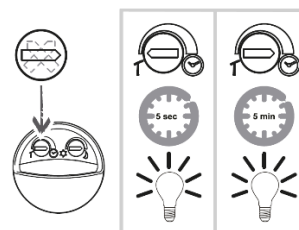

The light source of this luminaire is non-replaceable, at the end of its service life the entire luminaire must be replaced and disposed of in a designated place. This product contains a light source that for design reasons cannot be removed for verification and therefore the entire product is considered a light source.