

Thank you for purchasing our outdoor wall lighting equipment. This is a designer LED lighting for two GU10 bulbs (bulbs not included). The device is suitable for installation on outdoor walls as well as indoors. Please read these instructions carefully and pay attention to the safety warnings and instructions before installing and using the device. This will ensure not only the protection of persons, but also the long-term viability of the equipment. Do not repair or modify the equipment; installation must only be carried out by a qualified technician. The operating temperature of the equipment is between -20°C and 50°C.

TECHNICAL PARAMETERS

	WO811
Power	220-240V AC
Bulb socket	2x GU10 (max. 30W)
Degree of protection	IP54
Dimensions	110 x 75 x 200mm

INSTALLATION

Disconnect the power supply before installation!

1. Unscrew the semi-transparent covers and screw on the GU10 bulbs on both sides of the device. Then reattach the covers.
2. Unscrew the screws on the bottom of the device.
3. Remove the bottom cover.
4. Push the supply cable through the rubber hole in the base plate. (If the cable cannot be pushed through, make a thin hole in the rubber seal).
5. Insert the dowels into the pre-drilled holes and screw the bottom cover into the selected location.
6. Connect the supply cable to the terminal block and make sure the connection is correct! (The wiring designation is marked on the terminal block)
7. Attach the top of the device to the bottom cover.
8. Screw in the side screws.
9. Switch on the power supply.

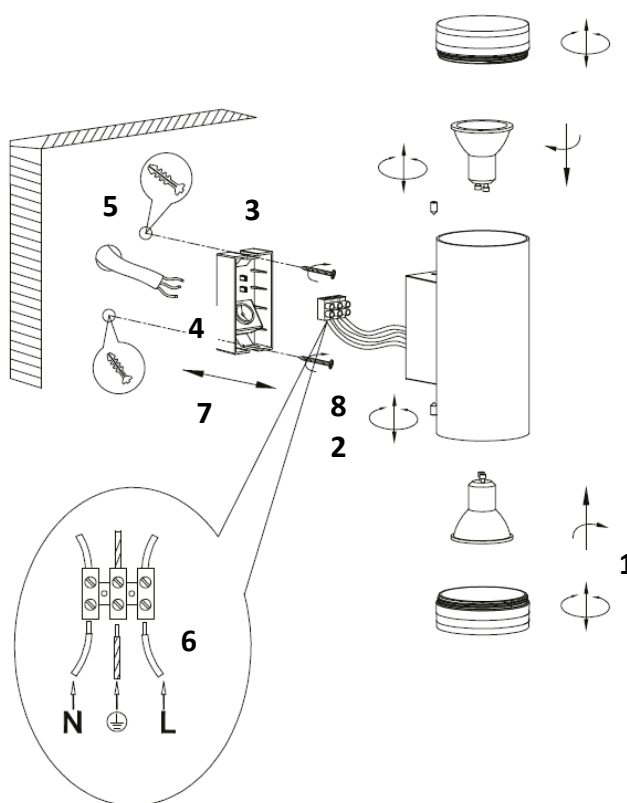

SAFETY NOTICE

- Installation may only be carried out by a qualified worker qualified in accordance with Decree No. 50/1978 Coll., as amended, at least a worker knowledgeable in accordance with § 5 of Decree No. 50/1978 Coll., as amended.
- Do not cover the luminaire with anything or hang anything on it.
- Do not repair or modify the equipment in any way.

