

## EN LED floor lamp Solight WO62

Dear customer, thank you for purchasing our product. Please read the following instructions carefully and follow them to serve you safely and to your full satisfaction. This will prevent misuse or damage. Avoid unprofessional handling of this appliance and always observe the electrical appliance usage guidelines. Keep the instruction manual carefully.

### Notice

- Avoid placing the luminaire near objects that are sources of heat or moisture.
- Do not look directly at a lit luminaire for long periods of time as this may cause discomfort or damage to your eyes.
- Do not expose the luminaire to the outdoor environment, direct rain or immerse it in water. The luminaire is intended for indoor use.
- Periodically wipe the luminaire with a dry or damp cloth only when the luminaire is unplugged.

### Installation

First, assemble the individual parts. Then install the LED strip. Put on the cover and then the cap on top. Proceed to assemble the base. Tighten the screws. Finally, plug in the power adapter.

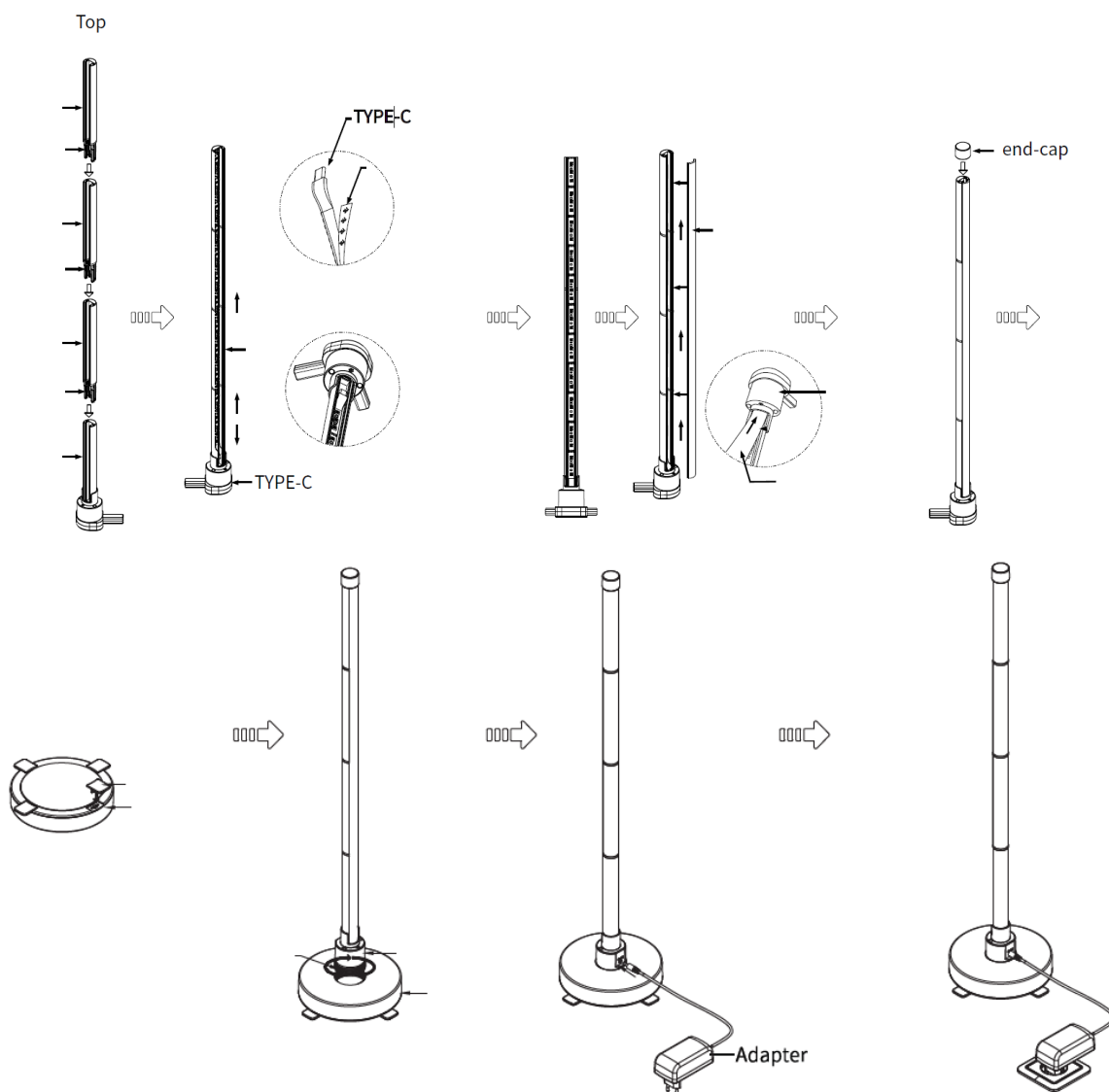

### Parameters

	Luminaire	Remote control
Input	DC 12 V	Battery CR2025 3 V
Power	18 W	
Operating temperature	-20 °C ~ +60 °C	
Controller range	5 m	

## Remote control

1	<b>Pause/Play</b>	Stop/start the effect
2	<b>Music mode</b>	Press to activate the music mode, in which the light changes to the rhythm of the music. Further presses cycle through the different music modes.
3	<b>ON/OFF/Wifi</b>	Short presses turn the light on and off. When the light is on, press and hold the button for 5 seconds to enter Wi-Fi mode.
4	<b>Automatic mode switching</b>	Automatic mode switching. Each mode lasts 30 sec.
5	<b>Mode switching</b>	Forward mode change
6	<b>Mode switching</b>	Reverse mode change
7	<b>Reducing the speed of the effect</b>	Change the effect speed in music mode
8	<b>Increase the speed of the effect</b>	Change the effect speed in music mode
9	<b>Increase brightness</b>	Changing the brightness in static lighting mode
10	<b>Brightness reduction</b>	Changing the brightness in static lighting mode
11	<b>Chromaticity change</b>	Changing chromaticity towards cool white
12	<b>Chromaticity change</b>	Changing chromaticity towards warm white
13	<b>Changing the light colour</b>	Change the light colour according to the button colour

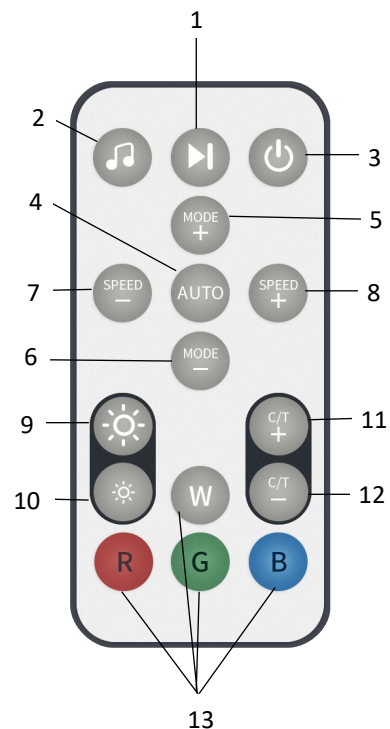

## Smart Life app

**STEP 1** Search Google Play or the App Store for the Smart Life app and install it.

**STEP 2** Register a new account using your email or phone number and log in to the app.

### STEP 3 Switch to pairing mode

In order to pair the luminaire with the Smart Life app, it needs to be switched to pairing mode. This is indicated by flashing and is activated by plugging and unplugging the luminaire 4 times in succession. After the fourth plugging in, you need to wait a few seconds and the strip will flash.

### STEP 4 Add a device

Launch the Smartlife app and tap the "+" button in the top right corner -> Lighting -> Lights (Wi-Fi). Then enter the login details of the wifi network your phone is currently connected to and tap "Next". On the next screen, confirm by tapping "Confirm the light is blinking rapidly;" that the light is blinking rapidly and then tap "Next". The pairing process takes a while. After successful pairing, the device will appear in the overview on the main screen of the app.

**STEP 4** Tap the device to control it according to the functions offered by the app you downloaded, e.g. the Smart Life app mentioned above.

You can find the video guide on Youtube by searching for the term *solight led smart wifi* or scan the QR code

**Note:** The lights can only be connected to 2.4GHz WIFI.

The product is covered by a declaration of conformity in accordance with the applicable regulations. On request from the manufacturer: [info@solight.cz](mailto:info@solight.cz), or downloadable from [www.solight.cz](http://www.solight.cz). This product contains a light source which for design reasons cannot be removed for verification and therefore the whole product is considered to be a light source.



Smart Life  
Google Play



Smart Life  
App Store



**Producer:** Solight Holding, s.r.o., Na Brně 1972, Hradec Králové 500 06, Czech Republic

**CE**  **IP20**